

© Farm & Home Publishers, Ltd.

# NAHMA SE T-40-N • R-19-W

See Page 91-92 For Additional Names.

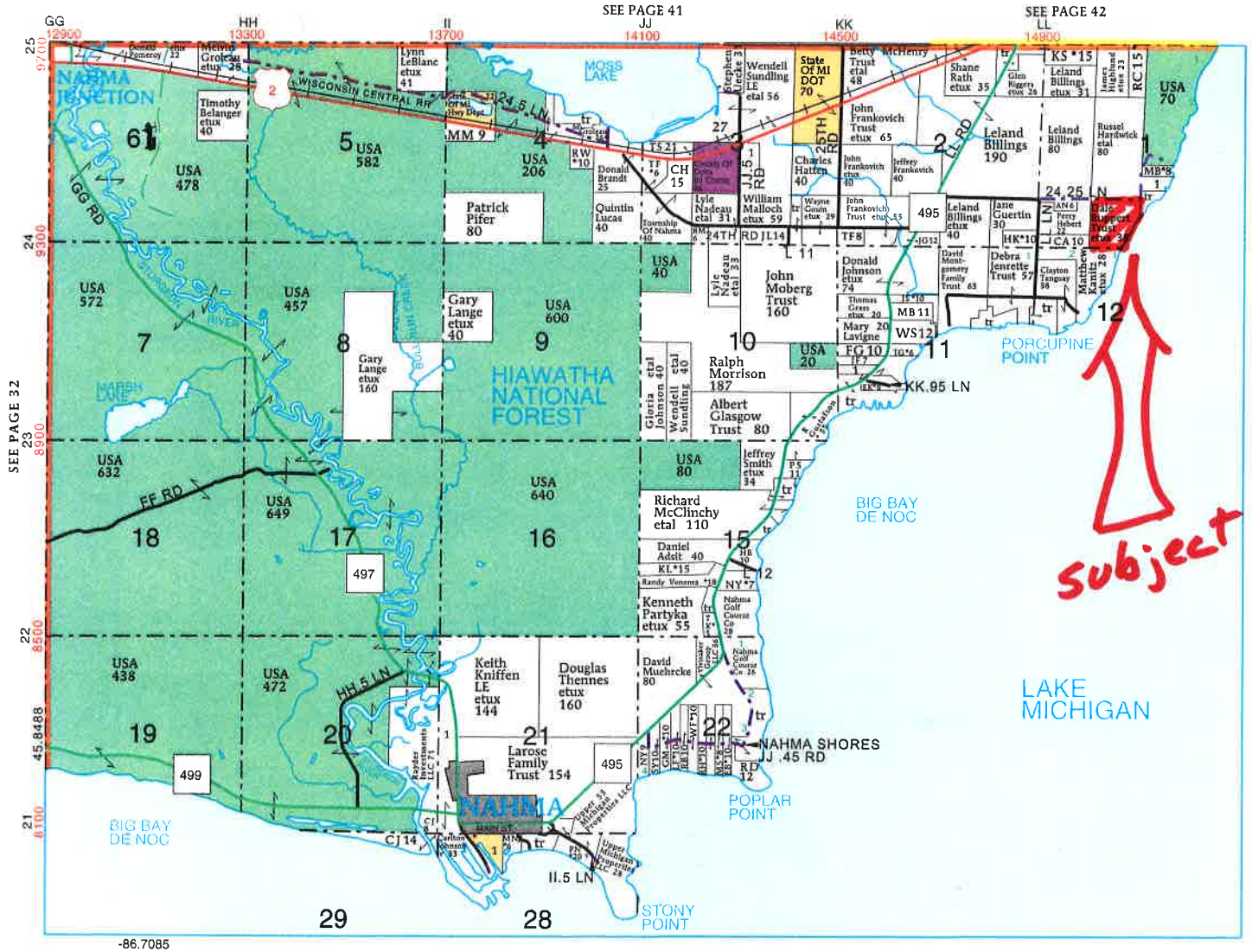

*subject*

LAKE MICHIGAN

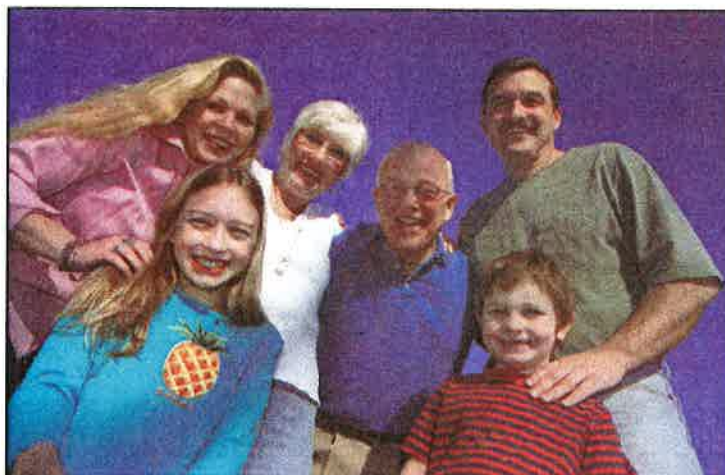

## Want to join 4-H?

Want to join 4-H or have your children involved in 4-H? Here's how to join.

Call the Delta 4-H Council at 906-786-3032 and indicate you want information on joining 4-H. You'll be referred to a club near you. Contact the club and start attending meetings.

It's that simple! Don't wait!

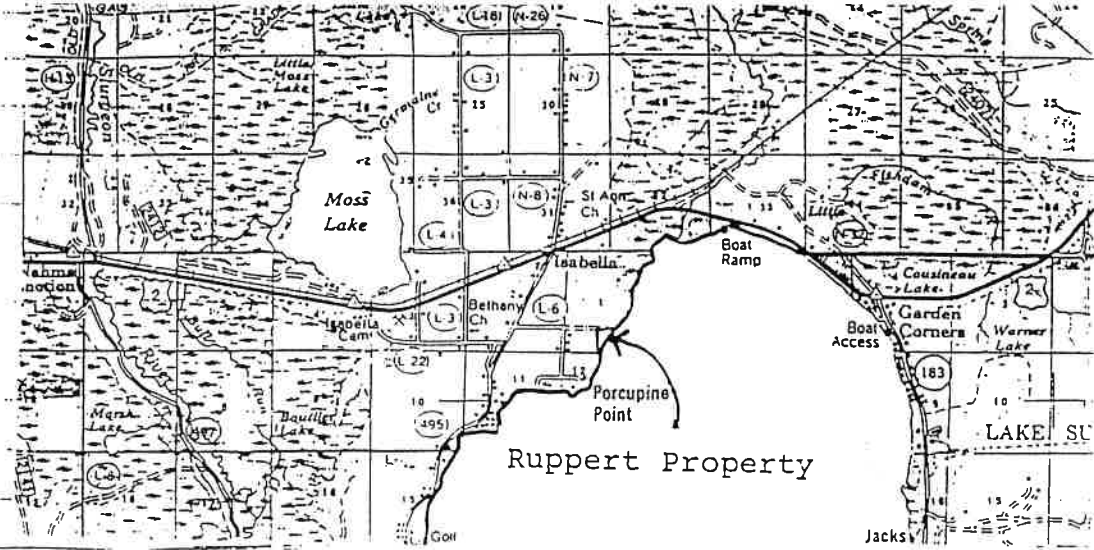

LOCATION MAP

Location Sketch - Proposed Wetland Fill

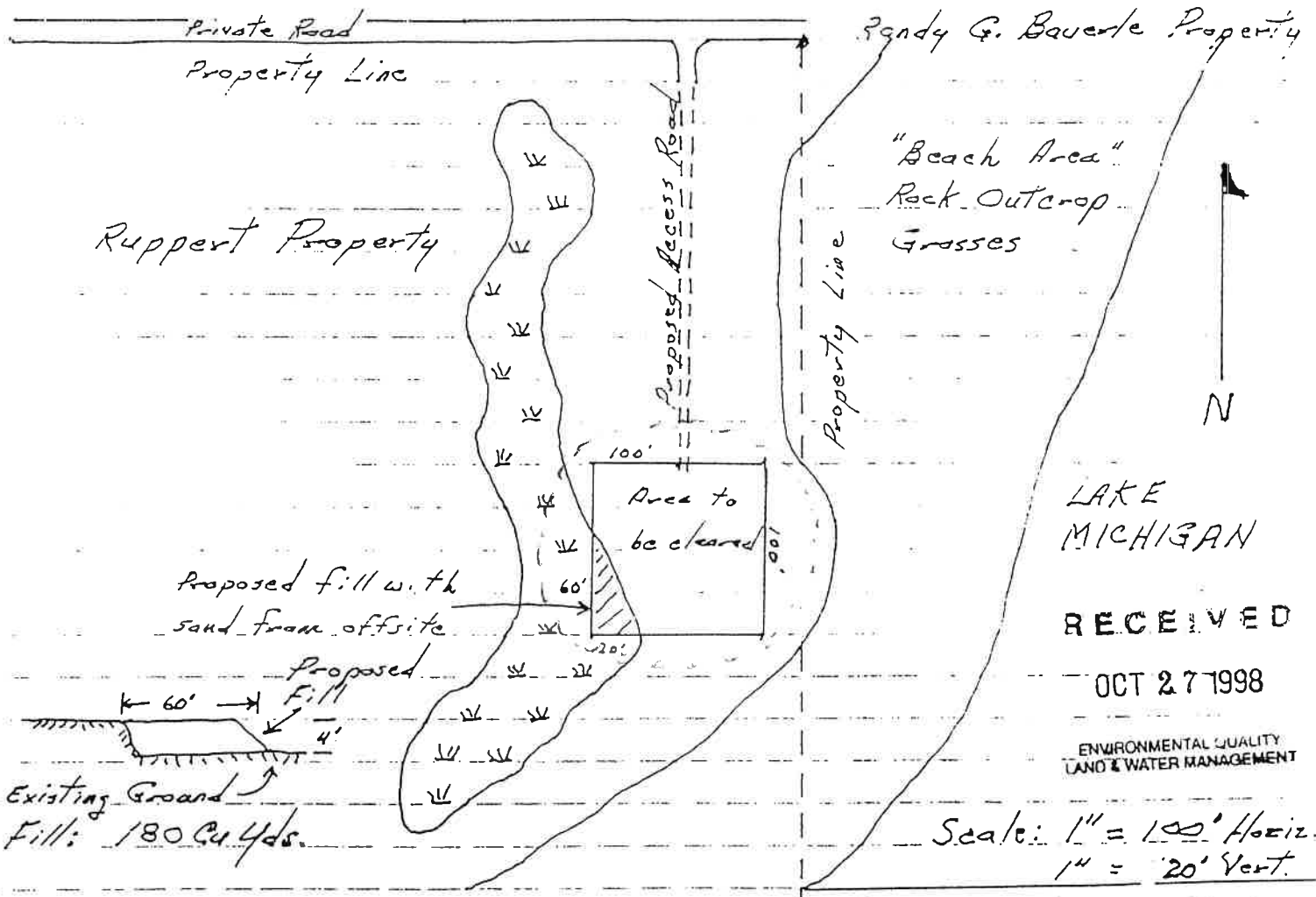

LAKE MICHIGAN

RECEIVED  
OCT 27 1998

ENVIRONMENTAL QUALITY  
LAND & WATER MANAGEMENT

Scale: 1" = 100' Horiz.  
1" = 20' Vert.

PROPOSED WETLAND FILL

DELTA COUNTY  
NAHMA TOWNSHIP  
GOVT LOT 4 Sec. 1 T40N R19W

Edward C. Butler Property

Robert Panek Revised  
June 24, 1998 10/13/98